



# LA GARD

June 1, 2010

To Our Valued Distribution Partners and Customers:

## **RE: PRICE INCREASE ANNOUNCEMENT**

**Effective July 1, 2010** an across-the-board LIST price increase of approximately 5% will be applied to all standard **LA GARD** brand products. Enclosed you will find List Price Book #4 reflecting these changes. You may also visit [www.kaba-mas.com](http://www.kaba-mas.com) for corrections and additional modifications at any time.

As with previously announced price increases, any orders placed on or after July 1, 2010 will be priced according to these "new" list prices. Only previously agreed to bid contracts with a formal expiration date will be price protected. Once these quotations expire, all future orders will be priced to the current list prices at that time.

Thank you for your continued business support.

Sincerely,

A handwritten signature in black ink, appearing to read "Stephen Pollack". The signature is written in a cursive, flowing style.

Stephen Pollack  
Marketing Director

The Kaba Safe Lock Division relies on product innovation to meet our markets' ever-changing needs for loss prevention and asset control solutions. The Kaba and LA GARD brands are synonymous worldwide with Security, Control and Accountability.

The background features a colorful, multi-colored grid pattern. In the top left, there is a white plastic component with a circular opening and the text 'LA GARD' below it. In the top right, there is a black keypad with a numeric keypad and the text 'LA GARD' above it. In the bottom left, there is a black keypad with a numeric keypad and the text 'LA GARD' above it. In the bottom center, there is a yellow circular component with four buttons labeled 'A 1', 'BCD 2', 'EFG 3', and 'H 4'.

# LA GARD

**LA GARD**

## LA GARD List Price Book #4

Rev A • August 19, 2010

Limited Warranty .....2  
Terms and Conditions .....3-4

**MECHANICAL SERIES ..... 5-12**

    3390 - 3-Wheel Combination Lock ..... 6  
    1985 - 3-Wheel, 1947 - 4-Wheel Combination Locks.....7  
    2270 Key Lock, Key Lock Components ..... 8  
    Dial and Ring Assemblies and Components .....9-12

**BASIC SERIES (3802).....13-15**

**COMBOGARD PRO SERIES (39E).....16-18**

**AUDITGARD SERIES (66E).....19-22**

**SMART SERIES ..... 23-32**

    SmartLinc - 9 User .....24-26  
    SmartLinc II - 99 User .....27-29  
    SmartPoint - 99 User, Biometric ..... 30-32

**ELECTRONIC ACCESSORIES .....33-34**

Kaba Mas LLC ("Kaba Mas") warrants to the original purchaser that the product(s) shall be free of defects in material and workmanship for a period of **one (1) year from the date of manufacture by Kaba Mas (complete locks), and sixty (60) days (parts)**. This warranty applies provided there is compliance with all installation/operating instructions supplied by Kaba Mas and, provided further, that the product has been subject to normal use without any misuse, negligence, modification, or the occurrence of any accidental damage.

**Kaba Mas MAKES NO OTHER WARRANTY WITH RESPECT TO THE PRODUCT, EXPRESSED OR IMPLIED, INCLUDING WITHOUT LIMITATION ANY WARRANTY AS TO SUITABILITY OF THE PRODUCT FOR ANY PARTICULAR PURPOSE OR USE OR THE MERCHANTABILITY THEREOF AND SHALL NOT BE LIABLE FOR ANY LOSS OR DAMAGE SUSTAINED THROUGH BURGLARY, THEFT, ROBBERY, FIRE OR OTHER HAZARD. THIS LIMITED WARRANTY IS IN LIEU OF ALL OTHER WARRANTIES OR CONDITIONS EXPRESSED OR IMPLIED BY LAW AND/OR CUSTOM.**

In the event of a defect in materials or workmanship covered by this warranty, the purchaser shall return, at purchaser's expense, the product to Kaba Mas for repair or replacement. Repair or replacement shall be at the election of Kaba Mas. The purchaser's sole remedy shall be the repair or replacement of the product and under no circumstances shall Kaba Mas be liable to the purchaser or any other person for any consequential, incidental, economic, direct, indirect, general or special damages arising out of any breach of warranty. In no event shall Kaba Mas's liability exceed the original cost of the product.

This warranty and remedies set forth above are exclusive and in lieu of all others, oral or written, expressed or implied. No dealer, distributor, agent or employee is authorized to make any modification or addition to this warranty.

**Kaba Mas EXPRESSLY DISCLAIMS ANY WARRANTY OF NON-INFRINGEMENT PROVIDED UNDER KRS 355.2.312, UCC §2-312, OR SIMILAR LAW. KABA MAS SHALL NOT INDEMNIFY NOR BE RESPONSIBLE FOR ANY DAMAGES ARISING OUT OF A CLAIM THAT THIS PRODUCT INFRINGES ANY PATENT.**

Some states do not allow the exclusion or limitation of implied warranties or limitation of liability for incidental or consequential damages, so the above limitation or exclusion may not apply to you.

**NOTICE**

**Installation of authentic LA GARD brand products with any unauthorized accessorial item or product will invalidate the Kaba Mas LLC Limited Product Warranty.**

**Terms and Conditions**

All sales will be subject to the terms and conditions set forth herein, and any terms and conditions contained in any orders contrary to these terms and conditions will be null and void. Kaba Mas reserves the right to immediately and without further notice discontinue the selling of products to any customer that does not fully comply with these terms and conditions. Customer may not assign any rights or obligations without prior written consent of Kaba Mas.

**Products and Prices**

All prices of the products are set forth in the List Price Book. Kaba Mas reserves the right to amend such prices from time to time, and to discontinue the production of any product, or to change the design, function and finish thereof, without prior notice to the customer.

**Credit Issues**

Kaba Mas retains a purchase money security interest in all goods and materials which have been or are hereafter acquired by customer with credit granted by Kaba Mas ("Collateral"). Upon any default by customer, Kaba Mas shall have the rights of a secured party under the Uniform Commercial Code as adopted by the Commonwealth of Kentucky, as amended upon any default by customer. Kaba Mas may require customer to assemble the Collateral at a place designated by Kaba Mas. Customer shall reimburse Kaba Mas for all costs (including reasonable attorney's fees) incurred in collecting any amounts due to Kaba Mas or executing its interest hereunder. In addition to any other right or remedy hereunder, Kaba Mas shall have at all times the right to offset any obligation of customer to Kaba Mas against any obligation of Kaba Mas to customer. If in Kaba Mas's sole judgement any doubt arises at any time as to the ability of the customer to pay for the products, or if the customer at any time is past due in payment of any amount owing to Kaba Mas, Kaba Mas may (without liability and without prejudice to any remedies, and regardless of any schedule of shipment or payment to the contrary), delay production, postpone any shipment or stop any product in transit until Kaba Mas shall have received payment in full of all amounts, whether or not then due, owing to it by the customer. In case of any such postponement, the price of the products affected shall be the price in effect on the date of final shipment. Payment terms are Net 30 days unless otherwise specified. Any action or proceeding brought by customer of Kaba Mas arising out of these terms shall be brought solely in a court of competent jurisdiction located in Fayette County, Kentucky.

**Warranty**

Customer shall forever indemnify, defend and hold harmless Manufacturer from and against any and all losses, damages, costs (including, without limitation, attorney fees and court costs), expenses, claims, liabilities, obligations and judgements related to the product or the sale or use thereof to the extent not covered by Kaba Mas's warranty, including without limitation, by reason of any unauthorized warranties or representations with respect thereto. Customers shall promptly notify Kaba Mas of all charges, complaints or claims concerning the product, whether or not covered by Kaba Mas's warranty, and shall fully cooperate with Kaba Mas in investigating and resolving the same. The customer shall not repair, replace, modify or tamper with any product for warranty purposes unless the written consent of Kaba Mas is first obtained.

**Taxes**

Any taxes, duties, levies or other charges now hereafter imposed directly or indirectly on Kaba Mas or required to be collected directly or indirectly by Kaba Mas by any taxing authority in connection with the sale, delivery, use or consumption of the products, including, without limitation, any sales, documentary, use, excise, purchase, turnover and import taxes, consular fees and customs duties shall be for the account of the customer, and the customer shall on demand forthwith pay to Kaba Mas any such tax, levy or charge.

**Promotion of Products**

The customer shall sell and promote the products in a manner which will enhance the image and good will of Kaba Mas, its customer and the products. The use of Kaba Mas's trademarks and name is strictly prohibited without prior written consent of Kaba Mas.

**Minimum Orders**

**Minimum order amount per shipment is \$100.00 net.**

**Order Acknowledgements**

All Kaba Mas orders will be acknowledged in writing within three (3) business days after receipt of all information pertinent to the order. It is the responsibility of the customer to check all acknowledgements in order to ascertain that they conform to their purchase order. All estimates of dates of delivery are made by Kaba Mas in good faith, and are not guaranteed.

**Cancellations/Changes**

Requests for cancellations or changes must be received by Kaba Mas within 5 business days of order acknowledgement date. Kaba Mas reserves the right to impose a re-stocking fee, as a percentage of the value of the merchandise, should a cancellation or change be made after production has begun.

**Claims**

Claims for shortages or errors in packaging must be made to Kaba Mas in writing within ten (10) business days after receipt of shipment.

**Returned Merchandise**

Returns will not be accepted without prior written approval by Kaba Mas and without a Returned Goods Authorization Number issued by Kaba Mas's Customer Service Department. All returns are subject to a re-stocking charge. Purchaser must provide invoice number and information regarding original date of shipment with all returned goods. Electronic components sold under the Parts Program are not returnable under any circumstances.

**Shipments**

All products shall be shipped F.O.B. factory and shall be deemed the property of the customer when accepted by the carrier. Unless otherwise agreed in writing, the choice of carrier shall be at Kaba Mas's sole discretion. A service fee of \$25.00 (net) will be applied to all orders drop shipped at the request of the customer.

**Force Majeure**

Kaba Mas shall be excused for any delay in performance hereunder and shall not be responsible for any loss or damage caused by acts of God; accident or casualty; war or warlike activities; insurrection or civil commotion; supply, labor, engineering, or transportation difficulties; acts of any government (with or without valid jurisdiction); strikes; blockades; boycotts, lockouts or any other causes, whether or not similar in nature to those specified herein, beyond Kaba Mas's control. The provision as regards strikes, blockades, boycotts and lockouts shall apply irrespective of whether Kaba Mas itself is the subject or instigator of such a measure. Performance by Kaba Mas hereunder shall be suspended during the continuance of any such measure.

# MECHANICAL SERIES

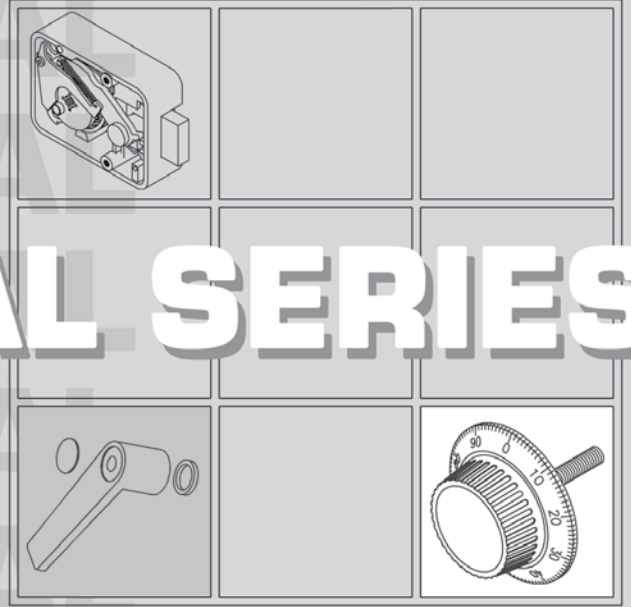

## LA GARD

### Mechanical

- 3390 - Group 2M, 3-Wheel Combination Lock
- 1985 - Group 1, 3-Wheel Combination Lock
- 1947 - Group 1, 4-Wheel Combination Lock
- 2270 - Key Lock
- Dials, Dial Rings
- Components

New Lock Identification Numbering (LIN) System -  
3390 Series

**Step 1: Select Model**

|   |   |   |   |
|---|---|---|---|
| 3 | 3 | 9 | 0 |
|---|---|---|---|

**Step 2: Select Certification Agency**

**Step 3: Not used for this series**

|   |
|---|
| Z |
|---|

**Step 4: Select Switch Options**

**Step 5: Select Bolt**

**Step 6: Not used for this series**

|   |   |   |
|---|---|---|
| Z | Z | Z |
|---|---|---|

**Step 7: Select Relocker Option**

**Step 8: Select Install Kit**

**Step 9: Select Packaging**

3390 3-Wheel Combination Lock

| Model | Description                                | LIN (Lock Identification Number) | List    |
|-------|--|----------------------------------|---------|
| 3390  | 3 Wheel Group 2M<br>Combination Mechanical | 3390XXXXXXXXXX                   | \$52.50 |

| Certification Agency | Description        | LIN (Lock Identification Number) | List     |
|----------------------|--------------------|----------------------------------|----------|
| S                    | United States (UL) | XXXXSXXXXXXXXXX                  | standard |
| V*                   | VdS                | XXXXVXXXXXXXXXX                  | \$5.25   |

\*Must select: Bolt Option 00, 03 or 20; Install Option 0 or 2

| Not Used | Description             | LIN (Lock Identification Number) | List   |
|----------|-------------------------|----------------------------------|--------|
| Z        | Not Used In This Series | XXXXXZXXXXXXXXXX                 | no add |

| Switches | Description                 | LIN (Lock Identification Number) | List    |
|----------|-----------------------------|----------------------------------|---------|
| N        | No Switch                   | XXXXXXNXXXXXXXXXX                | no add  |
| A        | Top Duress Only             | XXXXXXAXXXXXXXXXX                | \$31.50 |
| C        | Top Duress & Bolt Switch    | XXXXXXCXXXXXXXXXX                | \$63.00 |
| E        | Bottom Duress Only          | XXXXXXEXXXXXXXXXX                | \$31.50 |
| G        | Bottom Duress & Bolt Switch | XXXXXXGXXXXXXXXXX                | \$63.00 |
| K        | Bolt Switch Only            | XXXXXXKXXXXXXXXXX                | \$31.50 |

| Bolt | Description                  | LIN (Lock Identification Number) | List   |
|------|------------------------------|----------------------------------|--------|
| 00   | Standard Bolt (1.5")         | XXXXXXX00XXXXXX                  | no add |
| 03   | Metric Tapped Bolt M4 (1.5") | XXXXXXX03XXXXXX                  | \$3.15 |
| 05   | US Tapped Bolt 10-32 (1.5")  | XXXXXXX05XXXXXX                  | \$3.15 |
| 20   | EXT Bolt (2.4")              | XXXXXXX20XXXXXX                  | \$6.30 |

| Not Used | Description             | LIN (Lock Identification Number) | List   |
|----------|-------------------------|----------------------------------|--------|
| ZZZ      | Not Used In This Series | XXXXXXXXZZZXXX                   | no add |

| Relocker | Description            | LIN (Lock Identification Number) | List    |
|----------|------------------------|----------------------------------|---------|
| Y        | Universal Relocker Kit | XXXXXXXXXXXXYXX                  | \$10.50 |
| N        | No Relocker            | XXXXXXXXXXXXNXX                  | no add  |

| Install | Description     | LIN (Lock Identification Number) | List          |
|---------|-----------------|----------------------------------|---------------|
| 0       | No Hardware     | XXXXXXXXXXXX0X                   | deduct \$2.00 |
| 1       | STD Hardware    | XXXXXXXXXXXX1X                   | Standard      |
| 2       | Metric Hardware | XXXXXXXXXXXX2X                   | Standard      |

| Packaging | Description              | LIN (Lock Identification Number) | List     |
|-----------|--------------------------|----------------------------------|----------|
| A         | Distributor (Individual) | XXXXXXXXXXXXA                    | \$3.15   |
| B**       | OEM (Bulk)               | XXXXXXXXXXXXB                    | Standard |

\*\*24 per master carton

EXAMPLE

|       |   |   |   |          |     |        |      |   |     |   |   |          |         |           |
|-------|---|---|---|----------|-----|--------|------|---|-----|---|---|----------|---------|-----------|
| 3     | 3 | 9 | 0 | S        | Z   | N      | 0    | 0 | Z   | Z | Z | N        | 1       | B         |
| Model |   |   |   | Approval | N/A | Switch | Bolt |   | N/A |   |   | Relocker | Install | Packaging |



**1985 3-Wheel Combination Lock**  
**1947 4-Wheel Combination Lock**

**COMBINATION LOCKS - without Dials & Rings**

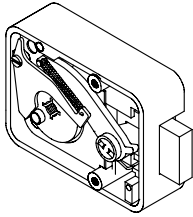

| <b>Part Number</b> | <b>Description</b>                                  | <b>Price</b> |
|--------------------|---|--------------|
| 1985               | Group 1, 3-Wheel Lock                               | \$75.60      |
| 1985000-03-00      | Group 1, 3-Wheel Lock, with Metric Tapped Bolt (M4) | \$78.75      |
| 1985A000-00-00     | Group 1, 3-Wheel Lock, with Relock Cover            | \$86.10      |
| 1985B000-00-00     | Group 1, 3-Wheel Lock, with Solenoid                | \$113.40     |
| 1985E000-00-00     | Group 1, 3-Wheel Lock, with Duress Switch           | \$107.10     |
| 1985F000-00-00     | Group 1, 3-Wheel Lock, with Bolt Switch             | \$107.10     |

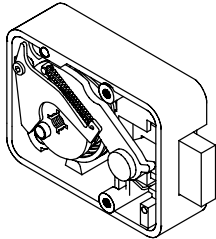

| <b>Part Number</b> | <b>Description</b>                                 | <b>Price</b> |
|--------------------|--|--------------|
| 1947               | Group 1, 4-Wheel Lock                              | \$84.00      |
| 19470000-03-00     | Group 1, 4-Wheel Lock with Metric Tapped Bolt (M4) | \$87.15      |
| 1947E000-00-00     | Group 1, 4-Wheel Lock with Duress Switch           | \$115.50     |
| 1947F000-00-00     | Group 1, 4-Wheel Lock with Bolt Switch             | \$115.50     |

**KEY LOCKS - without Keys**

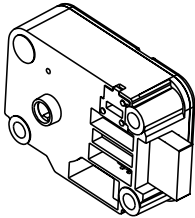

| Part Number    | Description  | Price    |
|----------------|--|----------|
| 2270           | Key Lock   | \$84.00  |
| 22700000-03-00 | Key Lock with Metric Tapped Bolt (M4)              | \$87.15  |
| 2270F000-00-00 | Key Lock with Bolt Switch                          | \$115.50 |
| 2270F000-03-00 | Key Lock with Bolt Switch, Metric Tapped Bolt (M4) | \$118.65 |

Keys sold separately

| Part Number | Description    | Price   |
|-------------|----------------|---------|
| 2226        | Key Hole Cover | \$28.88 |

**KEY LOCK COMPONENTS**

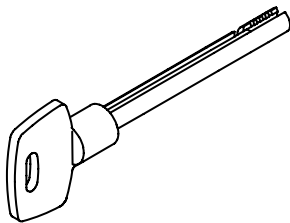

| Part Number | Description                 | Price   |
|-------------|-----------------------------|---------|
| 2212-02     | 3" Keys, Random Cut (Pairs) | \$34.65 |
| 2217-02     | 4" Keys, Random Cut (Pairs) | \$34.65 |
| 2218-02     | 5" Keys, Random Cut (Pairs) | \$34.65 |
| 2242-1-02   | 6" Keys, Random Cut (Pairs) | \$40.95 |

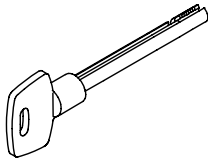

| Part Number | Description | Price   |
|-------------|-------------|---------|
| 2213        | Set-up Key  | \$17.85 |

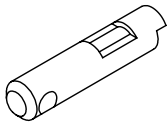

| Part Number | Description | Price   |
|-------------|-------------|---------|
| 2278        | Key Sheath  | \$19.95 |

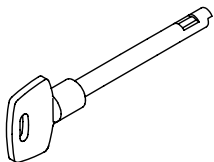

| Part Number | Description                   | Price   |
|-------------|-------------------------------|---------|
| 2280        | Key Extension Handle 12" Long | \$37.80 |

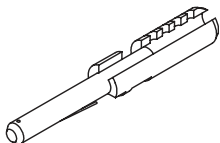

| Part Number | Description                  | Price   |
|-------------|------------------------------|---------|
| 2282-02     | Key Tips, Random Cut (Pairs) | \$44.10 |

**DIAL & DIAL RING ASSEMBLIES**

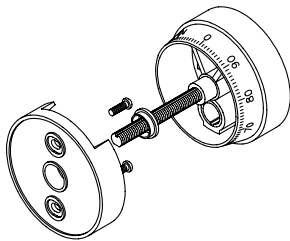

| Part Number     | Description  | Price   |
|-----------------|--|---------|
| 1730            | Restrict-A-Vision - Satin Chrome                   | \$39.90 |
| 1730SC000875001 | Restrict-A-Vision - Satin Chrome w/ 7.50" Spindle  | \$55.65 |
| 1730SC001275001 | Restrict-A-Vision - Satin Chrome w/ 11.50" Spindle | \$71.40 |
| 1730BK000000001 | Restrict-A-Vision - Black & White                  | \$34.65 |

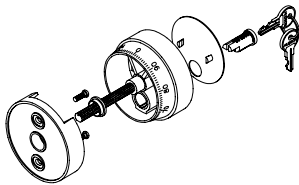

| Part Number     | Description   | Price   |
|-----------------|---|---------|
| 1731            | Restrict-A-Vision, Key Locking - Satin Chrome                 | \$44.10 |
| 1731SC0008750A1 | Restrict-A-Vision, Key Locking, Satin Chrome w/ 7.50" Spindle | \$59.85 |
| 1731SC0012750A1 | Restrict-A-Vision, Key Locking Satin Chrome w/ 11.50" Spindle | \$75.60 |
| 1731BK0000000A1 | Restrict-A-Vision, Key Locking - Black & White                | \$38.85 |

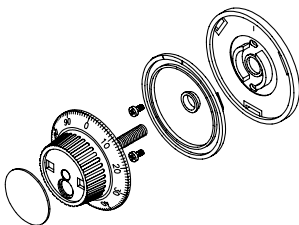

| Part Number     | Description                                | Price   |
|-----------------|--|---------|
| 1777            | Flat Gard - Satin Chrome                   | \$34.65 |
| 1777SC000875001 | Flat Gard - Satin Chrome w/ 7.50" Spindle  | \$50.40 |
| 1777SC001275001 | Flat Gard - Satin Chrome w/ 11.50" Spindle | \$66.15 |
| 1777BK000000003 | Flat Gard - Black & White                  | \$29.40 |

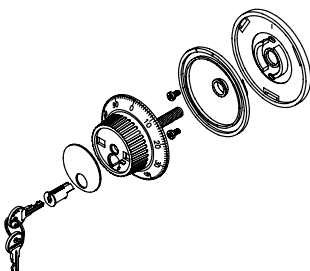

| Part Number     | Description   | Price   |
|-----------------|---|---------|
| 1779            | Flat Gard, Key Locking - Satin Chrome                   | \$38.85 |
| 1779SC0008750A1 | Flat Gard, Key Locking - Satin Chrome w/ 7.50" Spindle  | \$54.60 |
| 1779SC0012750A1 | Flat Gard, Key Locking - Satin Chrome w/ 11.50" Spindle | \$70.35 |

**DIAL & DIAL RING ASSEMBLIES**

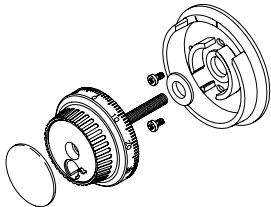

| Part Number     | Description   | Price   |
|-----------------|---|---------|
| 2085-SC         | VisionGard Dial & Ring - Satin Chrome                       | \$51.45 |
| 2085SC000875001 | VisionGard Dial & Ring - Satin Chrome<br>w/ 7.50" Spindle   | \$67.20 |
| 2085SC001275001 | VisionGard, Dial & Ring - Satin Chrome<br>w/ 11.50" Spindle | \$82.95 |
| 2085-G          | VisionGard Dial & Ring - Bright Brass                       | \$63.00 |
| 2085-BC         | VisionGard Dial & Ring - Bright Chrome                      | \$61.95 |
| 2085-B          | VisionGard Dial & Ring - Black & White                      | \$46.20 |

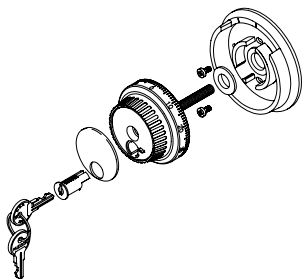

| Part Number     | Description  | Price   |
|-----------------|--|---------|
| 2090-SC         | VisionGard Key Locking Dial & Ring<br>Satin Chrome                   | \$55.65 |
| 2090SC0008750A1 | VisionGard Key Locking Dial & Ring<br>Satin Chrome w/ 7.50" Spindle  | \$71.40 |
| 2090SC0512750A1 | VisionGard Key Locking Dial & Ring<br>Satin Chrome w/ 11.50" Spindle | \$87.15 |
| 2090-G          | VisionGard Key Locking Dial & Ring<br>Bright Brass                   | \$67.20 |
| 2090-BC         | VisionGard Key Locking Dial & Ring<br>Bright Chrome                  | \$66.15 |
| 2090-B          | VisionGard Key Locking Dial & Ring<br>Black & White                  | \$50.40 |

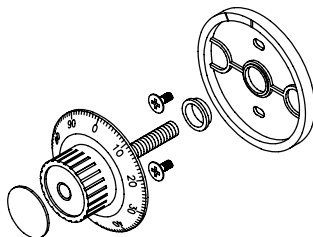

| Part Number     | Description                            | Price   |
|-----------------|--|---------|
| 2107            | Small Dial & Dial Ring - Satin Chrome  | \$26.25 |
| 2107BK000000003 | Small Dial & Dial Ring - Black & White | \$21.00 |

**DIAL COMPONENTS & ACCESSORIES**

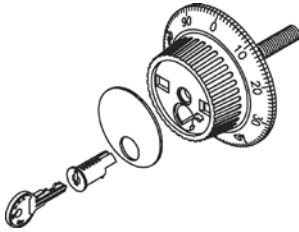

| Part Number | Description                                      | Price   |
|-------------|--|---------|
| 1762        | Flat Gard Dial Only, Key Locking<br>Satin Chrome | \$26.25 |

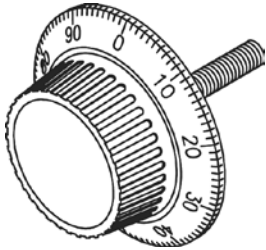

| Part Number | Description                        | Price   |
|-------------|------------------------------------|---------|
| 1763        | Flat Gard Dial Only - Satin Chrome | \$21.00 |

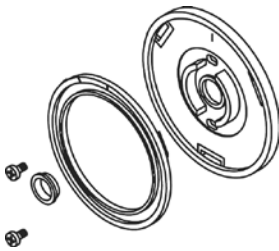

| Part Number | Description    | Price   |
|-------------|----------------|---------|
| 1764        | Dial Ring Only | \$17.85 |

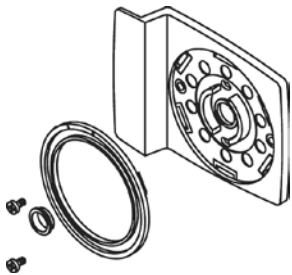

| Part Number | Description           | Price   |
|-------------|-----------------------|---------|
| 1776        | Dial Ring Pull Handle | \$40.95 |

**DIAL & DIAL RING ASSEMBLIES**

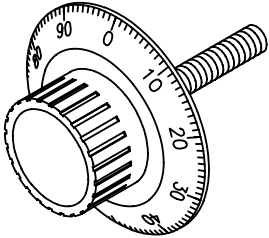

| Part Number | Description                     | Price   |
|-------------|---------------------------------|---------|
| 2106        | Small Dial Only - Satin Chrome  | \$18.90 |
| 2106B       | Small Dial Only - Black & White | \$17.85 |

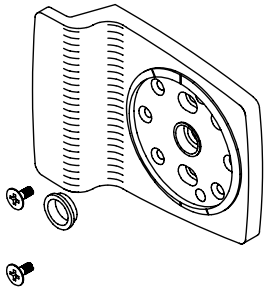

| Part Number | Description                                       | Price   |
|-------------|---|---------|
| 2109        | Small Dial Ring Pull Handle<br>Black without Dial | \$14.40 |

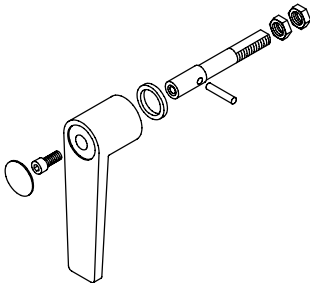

| Part Number | Description  | Price   |
|-------------|--|---------|
| 2300        | Handle Assembly with Stem<br>Satin Chrome            | \$33.10 |
| 2300-1      | Handle Assembly with Stem<br>Satin Chrome for 4-Bolt | \$40.95 |

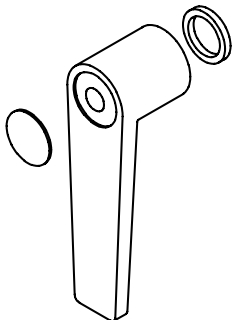

| Part Number | Description                                  | Price   |
|-------------|--|---------|
| 2301        | Handle Assembly without Stem<br>Satin Chrome | \$18.90 |

**NOTE:** Minimum order amount per shipment is \$100.00 net.

# BASIC SERIES

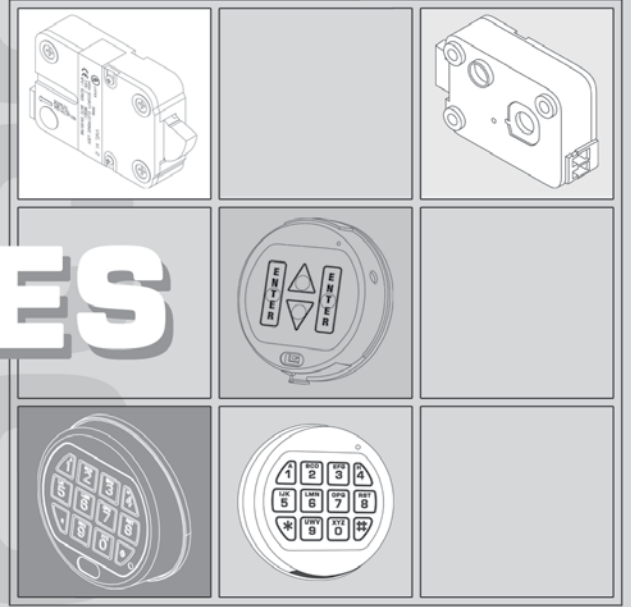

**LA GARD**

## **Basic 3802 Firmware**

### **Product Features**

- Manager Mode
  - Manager and One User Combination
- Wrong Try Penalty
- Dead Bolt or Swing Bolt
- Low Battery Signal
- UL, EN1300, Vds, DNV Certified

**SWING BOLT (MOTOR BLOCKING)**

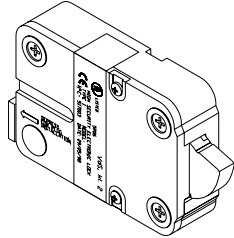

| Part Number     | Description                                | Price   |
|-----------------|--|---------|
| 4200M           | Swing Bolt, Dual-Handed, Standard Hardware | \$94.50 |
| 4200M0000-00-11 | Swing Bolt, Dual-Handed, Metric Hardware   | \$94.50 |

**DEAD BOLT (MOTOR BLOCKING)**

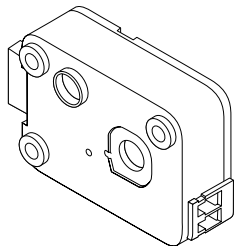

| Part Number     | Description  | Price    |
|-----------------|--|----------|
| 3740M           | Dead Bolt, Standard Hardware                               | \$113.40 |
| 3740M0000-00-10 | Dead Bolt, Metric Hardware                                 | \$113.40 |
| 3740M0000-53-10 | Dead Bolt, Metric Tapped Bolt (M4), Metric Hardware        | \$116.55 |
| 3740M0000-53-00 | Dead Bolt, Metric Tapped Bolt (M4), Standard Hardware      | \$116.55 |
| 3740M0000-70-00 | Dead Bolt, Extended Bolt (+1.4"), Standard Hardware        | \$119.70 |
| 3740M0000-70-10 | Dead Bolt, Extended Bolt (+1.4", 35.6 mm), Metric Hardware | \$119.70 |

**ENTRIES**

(Recommended)



(For use with Swing Bolt Only)

| Part Number   | Description                            | Finish        | Price   |
|---------------|--|---------------|---------|
| 3710          | Angular Round Entry, Standard Hardware | Satin Chrome  | \$57.75 |
| 3710SC0000-22 | Angular Round Entry, Metric Hardware   | Satin Chrome  | \$57.75 |
| 3710-BC       | Angular Round Entry, Standard Hardware | Bright Chrome | \$63.00 |
| 3710-BR       | Angular Round Entry, Standard Hardware | Bright Brass  | \$71.40 |
| 3710G00000-22 | Angular Round Entry, Metric Hardware   | Bright Brass  | \$71.40 |
| 3710-BK       | Angular Round Entry, Standard Hardware | Gloss Black   | \$55.65 |
| 3710BK0000-22 | Angular Round Entry, Metric Hardware   | Gloss Black   | \$55.65 |

| Part Number     | Description                            | Finish         | Price   |
|-----------------|--|----------------|---------|
| 3715            | Angular Round Entry, Standard Hardware | Satin Chrome   | \$55.65 |
| 3715SC000000-21 | Angular Round Entry, Metric Hardware   | Satin Chrome   | \$55.65 |
| 3715-BC         | Angular Round Entry, Standard Hardware | Bright Chrome  | \$60.90 |
| 3715-BR         | Angular Round Entry, Standard Hardware | Bright Brass   | \$69.30 |
| 3715-TB         | Angular Round Entry, Standard Hardware | Textured Black | \$53.55 |
| 3715TB000000-21 | Angular Round Entry, Metric Hardware   | Textured Black | \$53.55 |



(Optional)



(For use with Swing Bolt Only)

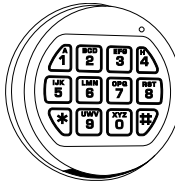
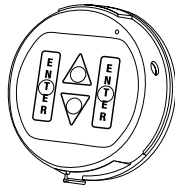

| Part Number   | Description                    | Finish       | Price    |
|---------------|--------------------------------|--------------|----------|
| 3000          | Round Entry, Standard Hardware | Satin Chrome | \$121.30 |
| 3000SC0000-21 | Round Entry, Metric Hardware   | Satin Chrome | \$121.30 |

| Part Number    | Description  | Finish       | Price    |
|----------------|--|--------------|----------|
| *3035          | Round Entry with 6" spindle, Standard Hardware                                 | Satin Chrome | \$110.25 |
| *3035SC0000-01 | Round Entry without spindle (Swing Bolt only) Standard Hardware                | Satin Chrome | \$105.00 |
| *3035SC0000-18 | Round Entry with 6" spindle, Metal Backplate, Metric Hardware                  | Satin Chrome | \$113.40 |
| *3035SC0000-19 | Round Entry without spindle (Swing Bolt only) Metal Backplate, Metric Hardware | Satin Chrome | \$108.15 |

\* Requires an external battery box (2788 or 4001).

| Part Number | Description                                   | Finish       | Price    |
|-------------|---|--------------|----------|
| 3190        | PRIVAT II Entry, Standard and Metric Hardware | Satin Chrome | \$267.75 |

| Part Number | Description                                      | Finish       | Price   |
|-------------|--|--------------|---------|
| 3750        | Angular Round Entry Standard and Metric Hardware | Satin Chrome | \$73.50 |
| 3750-BR     | Angular Round Entry Standard Hardware            | Bright Brass | \$85.05 |

**ACCESSORIES (Ordered Separately)**

| Part Number | Description                       | Price  |
|-------------|-----------------------------------|--------|
| 3716        | Dial Plate Adaptor for 3710 Entry | \$6.85 |

**BATTERY BOX**

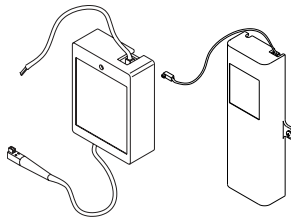

| Part Number | Description  | Price   |
|-------------|--|---------|
| 2788        | Small Battery Box (One 9v Battery Required)<br>(For 3035, 3125 Only)       | \$11.10 |
| 4001        | Large Battery Box (Six C Cell Batteries Required)<br>(For 3035, 3125 Only) | \$21.00 |

Batteries not included.

For replacement hardware packs, see Page 34.

NOTE: Minimum order amount per shipment is \$100.00 net.

# COMBOGARD Pro SERIES

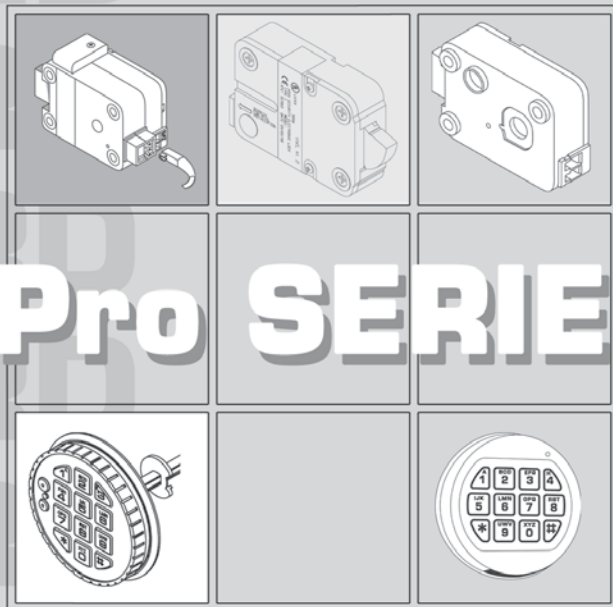

**LA GARD**

## **ComboGard Pro 39E Firmware Product Features**

- Manager Mode
  - Manager and Nine Users
- Wrong Try Penalty
- 63 Audit Events
- Lock may be set up either through Key Pad or PC Software (sold separately)
- Manager (Setup and Audits)
- Nine Users
- Time Delay
  - Delay Period: 1 – 99 minutes
  - Open Period: 1 – 19 minutes
- Time Delay Override (User 9)
- Dual Code Mode
- Silent Signal Alarm
  - Optional Alarm Box required (sold separately)
- Remote Override Signal
  - Optional Alarm Box required (sold separately)
- UL, EN1300, VdS, DNV certified

The use of a Large Battery Box is recommended if Time Delay is operational

**SWING BOLT (Motor Blocking)**

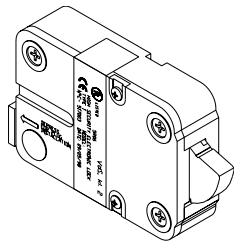

| Part Number     | Description  | Price    |
|-----------------|--|----------|
| 4300M002U-00-00 | Swing Bolt, Dual Handed, Standard Hardware                                       | \$157.50 |
| 4300M002U-00-11 | Swing Bolt, Dual Handed, Metric Hardware   | \$157.50 |
| 4300MU02U-00-00 | Swing Bolt, Dual Handed Isolated Ground, Standard Hardware                       | \$157.50 |
| 4300MU02U-00-11 | Swing Bolt, Dual, Isolated Ground, Metric Hardware                               | \$157.50 |
| 4300MJU2U-00-00 | Swing Bolt, Dual Handed, Isolated Ground, Bolt Sensing Switch, Standard Hardware | \$173.25 |
| 4300MJU2U-00-11 | Swing Bolt, Dual Handed, Isolated Ground, Bolt Sensing Switch, Metric Hardware   | \$173.25 |

**DEAD BOLT (Motor Blocking)**

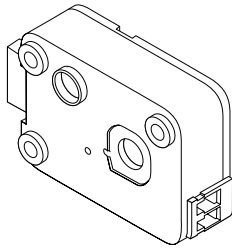

| Part Number     | Description   | Price    |
|-----------------|---|----------|
| 6040M002U-00-00 | Dead Bolt, Standard Hardware  | \$168.00 |
| 6040M002U-00-10 | Dead Bolt, Metric Hardware  | \$168.00 |
| 6040M002U-53-10 | Dead Bolt, Metric Tapped Bolt (M4), Metric Hardware                               | \$171.15 |
| 6040MU02U-00-00 | Dead Bolt, Isolated Ground, Standard Hardware                                     | \$173.25 |
| 6040MU02U-00-10 | Dead Bolt, Isolated Ground, Metric Hardware                                       | \$173.25 |
| 6040MU02U-53-10 | Dead Bolt, Isolated Ground, Metric Tapped Bolt (M4), Metric Hardware              | \$176.40 |
| 6040MJU2U-00-00 | Dead Bolt, Isolated Ground, Bolt Switch   | \$183.75 |
| 6040MJU2U-53-10 | Dead Bolt, Isolated Ground, Bolt Switch, Metric Tapped Bolt (M4), Metric Hardware | \$186.90 |
| 6040MU02U-70-00 | Dead Bolt, Isolated Ground, Extended Bolt (+1.4"), Standard Hardware              | \$176.40 |
| 6040MU02U-70-10 | Dead Bolt, Isolated Ground, Extended Bolt (+1.4", 35.6 mm), Metric Hardware       | \$176.40 |

**REDUNDANT MECHANICAL LOCKS (not VdS Certified)**

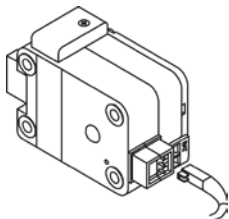

| Part Number     | Description  | Price    |
|-----------------|--|----------|
| *6441IU2U-40-00 | Redundant Mechanical 4-Wheel Lock, Standard Hardware | \$258.30 |

\* Requires Dial & Dial Ring sold separately.

**ENTRIES**

(Recommended)

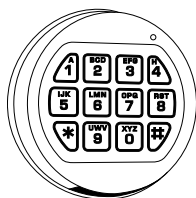

| Part Number | Description   | Finish       | Price   |
|-------------|---|--------------|---------|
| 3750-K      | Angular Round Entry<br>Standard and Metric Hardware | Satin Chrome | \$89.25 |

### Entries (Recommended) cont.



| Part Number    | Description  | Finish       | Price    |
|----------------|--|--------------|----------|
| *3125          | Round Entry with 6" spindle, Standard Hardware                                 | Satin Chrome | \$126.00 |
| *3125SC0000-01 | Round Entry without spindle (Swing Bolt only), Standard Hardware               | Satin Chrome | \$120.75 |
| *3125SC0000-18 | Round Entry with 6" spindle, Metal Backplate, Metric Hardware                  | Satin Chrome | \$129.15 |
| *3125SC0000-19 | Round Entry without spindle (Swing Bolt only) Metal Backplate, Metric Hardware | Satin Chrome | \$123.90 |

### Entries (Optional)



\* Requires an external battery box (2788 or 4001.)

| Part Number | Description   | Finish         | Price    |
|-------------|---|----------------|----------|
| 3190        | PRIVAT II Entry, Standard and Metric Hardware                         | Satin Chrome   | \$267.75 |
| 8130        | Entry with Integrated Time Delay Display Standard and Metric Hardware | Textured Black | \$450.00 |

### ACCESSORIES (Ordered Separately)

#### Battery Box

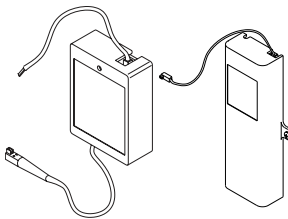

| Part Number | Description   | Price   |
|-------------|---|---------|
| 2788        | Small Battery Box (One 9v Battery Required)                               | \$11.10 |
| 4001        | Large Battery Box (Six C Cell Batteries Required)                         | \$21.00 |
| 2789-NC*    | Small Alarm/Battery Box (Normally Closed) (One 9v Battery Required)       | \$78.75 |
| 4002*       | Large Alarm/Battery Box (Normally Closed) (Six C Cell Batteries Required) | \$94.50 |

\* Can be configured as either NC or NO by changing the internal jumper.

Batteries not included.

#### Programming & Audit

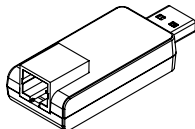
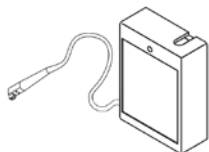

| Part Number | Description   | Price    |
|-------------|---|----------|
| 6066        | Lock Reset Box  | \$72.50  |
| 701117      | Software Implementation Kit (Included: ComboGard Pro Setup Version 5, Audit Software Version 2, USB Interface and Cables) | \$183.80 |
| 707013      | ComboGard Pro Setup and Auditing Software Only  | \$99.00  |

**NOTE:** Minimum order amount per shipment is \$100.00 net.

For replacement hardware packs, see page 34.

# AUDITGARD SERIES

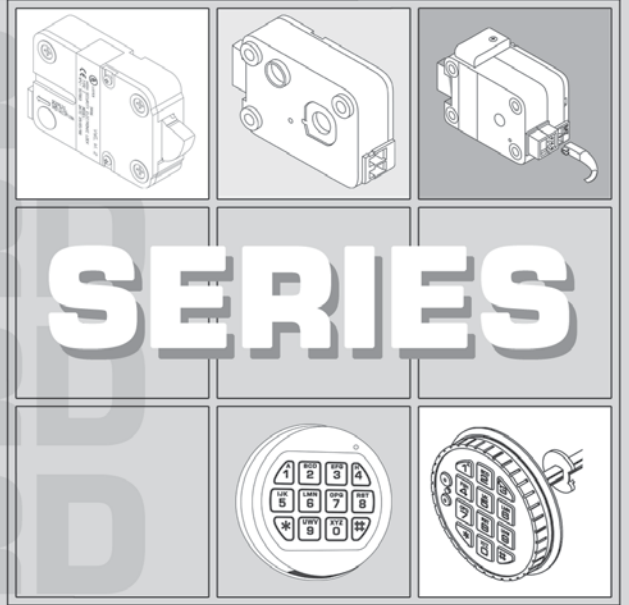

## LA GARD

### AuditGard 66E Firmware

#### Product Features

- Manager Mode
- External Connection for Audit Trail -  
Optional Audit Interface Required
- Internal Bolt Switch
- User Status Signal
- Wrong Try Penalty
- Signal to Disable Lock Opening
  - Optional Alarm Box Required
- UL, EN 1300, VdS, DNV Certified

- Time Delay - Key Pad or PC Programmable
  - Delay Period: 1-99 Minutes
  - Open Period: 1-19 Minutes
- External Emergency Power Terminals

#### PC Programmable Features

- Multiple Users - Up to 9
  - 1 Manager and 8 Users
- Time Delay Override (User 9)
- Silent Signal Alarm - Optional Alarm  
Box Required
- Signal to Disable All Lock Functions
  - Optional Alarm Box Required
- Dual Token (Factory  
Programming Required)
  - E Key or E Key II

**SWING BOLT (Motor Blocking)**

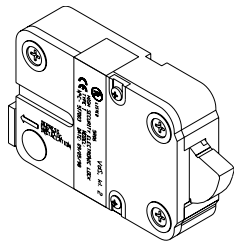

| Part Number     | Description   | Price    |
|-----------------|---|----------|
| 4300M           | Swing Bolt, Dual-Handed, Standard Hardware                                  | \$189.00 |
| 4300M0000-00-11 | Swing Bolt, Dual-Handed, Metric Hardware                                    | \$189.00 |
| 4300MP000-00-00 | Swing Bolt, Dual-Handed, Factory Programmed<br>for E-Key, Standard Hardware | \$204.75 |
| 4300MP000-00-11 | Swing Bolt, Dual-Handed, Factory Programmed<br>For E-Key, Metric Hardware   | \$204.75 |

**DEAD BOLT (Motor Blocking)**

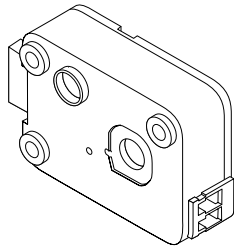

| Part Number     | Description  | Price    |
|-----------------|--|----------|
| 6040M           | Dead Bolt, Standard Hardware                                 | \$199.50 |
| 6040M0000-53-10 | Dead Bolt, Metric Tapped Bolt (M4), Metric Hardware          | \$202.65 |
| 6040M0000-53-00 | Dead Bolt, Metric Tapped Bolt (M4), Standard Hardware        | \$202.65 |
| 6040M0000-70-00 | Dead Bolt, Extended Bolt (+1.4"), Standard Hardware          | \$205.80 |
| 6040M0000-70-10 | Dead Bolt, Extended Bolt (+1.4", 35.6mm),<br>Metric Hardware | \$205.80 |
| 6040MP000-00-00 | Dead Bolt, Factory Programmed for E-Key<br>Standard Hardware | \$215.25 |
| 6040MP000-00-10 | Dead Bolt, Factory Programmed for E-Key,<br>Metric Hardware  | \$215.25 |

**REDUNDANT MECHANICAL LOCKS (Not VdS Certified)**

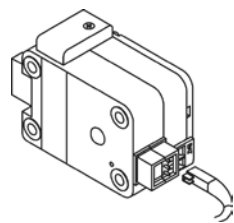

| Part Number     | Description  | Price    |
|-----------------|--|----------|
| *6441           | Redundant Mechanical 4-Wheel Lock<br>Standard Hardware       | \$303.45 |
| *6441I000-43-00 | Redundant Mechanical 4-Wheel Lock<br>Metric Tapped Bolt (M4) | \$305.55 |

\* Requires Dial and Ring sold separately.

**ENTRIES**

(Recommended)

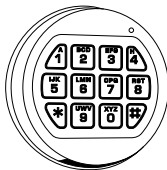

| Part Number | Description   | Finish       | Price   |
|-------------|---|--------------|---------|
| 3750-K      | Angular Round Entry (Audit & E-Key)<br>Standard and Metric Hardware | Satin Chrome | \$89.25 |

Entries (Recommended) cont.



| Part Number    | Description   | Finish       | Price    |
|----------------|---|--------------|----------|
| *3125          | Round Entry with 6" spindle, Standard Hardware                                    | Satin Chrome | \$126.00 |
| *3125SC0000-01 | Round Entry without spindle (Swing Bolt only)<br>Standard Hardware                | Satin Chrome | \$120.75 |
| *3125SC0000-18 | Round Entry with 6" spindle, Metal Backplate,<br>Metric Hardware                  | Satin Chrome | \$129.15 |
| *3125SC0000-19 | Round Entry without spindle (Swing Bolt only)<br>Metal Backplate, Metric Hardware | Satin Chrome | \$123.90 |

\* Requires an external battery box (2788 or 4001).

Entries (Optional)

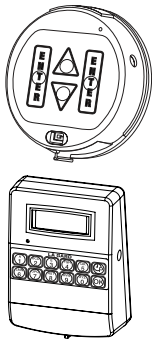

| Part Number | Description   | Finish         | Price    |
|-------------|---|----------------|----------|
| 3190        | PRIVAT II Entry, Standard and Metric Hardware                             | Satin Chrome   | \$267.75 |
| 8130        | Entry with Integrated Time Delay Display,<br>Standard and Metric Hardware | Textured Black | \$450.00 |

**ACCESSORIES (Ordered Separately)**

Battery Box

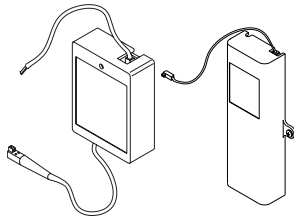

| Part Number | Description  | Price   |
|-------------|--|---------|
| 2788        | Small Battery Box (One 9v Battery Required)                                  | \$11.10 |
| 4001        | Large Battery Box (Six C Cell Batteries Required)                            | \$21.00 |
| 2789-NC*    | Small Alarm/Battery Box (Normally Closed)<br>(One 9v Battery Required)       | \$78.75 |
| 4002*       | Large Alarm/Battery Box (Normally Closed)<br>(Six C Cell Batteries Required) | \$94.50 |
| 701107      | AC Power Supply, Universal<br>with Multiple Adapter Plug Kit                 | \$99.75 |

\* Can be configured as either NC or NO by changing the internal jumper.

Batteries not included.

**Programming & Audit**

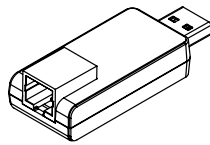
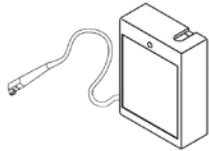

| <b>Part Number</b> | <b>Description</b>   | <b>Price</b> |
|--------------------|--|--------------|
| 6066               | Lock Reset Box   | \$72.50      |
| 701116             | Software Implementation Kit<br>(Included: ComboGard Pro Setup Version 5,<br>Audit Software Version 2, USB Interface and Cable) | \$183.80     |
| 707012             | AuditGard Setup and Auditing Software Only   | \$99.00      |

Audit Software available for download at [www.kaba-mas.com](http://www.kaba-mas.com).

**E-Key**

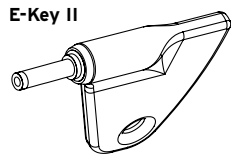
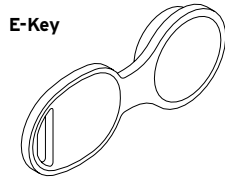

| <b>Part Number</b> | <b>Description</b>               | <b>Price</b> |
|--------------------|----------------------------------|--------------|
| 3122               | E-Key for 3125 Entry             | \$17.85      |
| 40169              | E-Key II for 3750-K, 8130 & 3190 | \$19.95      |

**NOTE:** Minimum order amount per shipment is \$100.00 net.  
For replacement hardware packs , see page 34.



# SMART SERIES

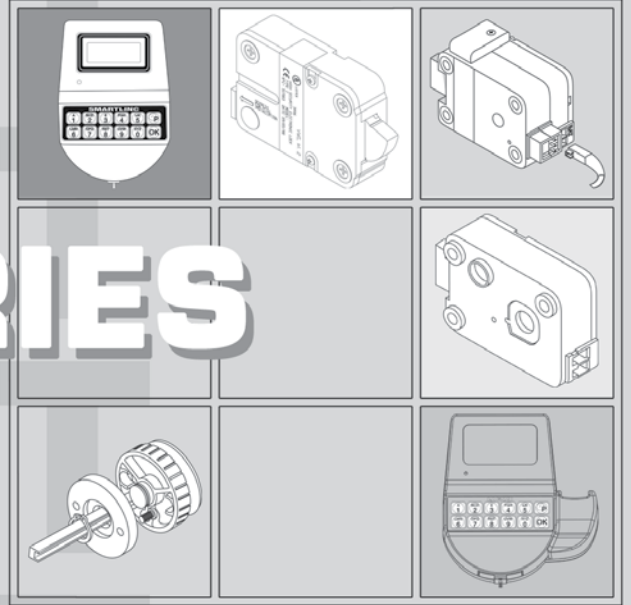

**LA GARD**

## **SmartLinc**

### **SmartLinc II**

- Serial Access Control
- Multi-User, Multi-Compartment Control
- Audit Trail
- Time Delay
- Time Lock

## **SmartPoint**

- Biometric Access Control
- Multi-User, Multi-Compartment Control
- Audit Trail
- Time Delay
- Time Lock

**LOCKS**

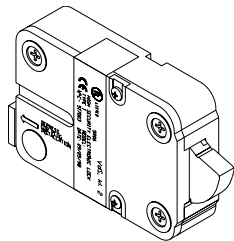

| Part Number    | Description                                    | Price    |
|----------------|--|----------|
| 4300002Q-00-00 | Dual-Handed Swing Bolt Lock, Standard Hardware | \$231.00 |

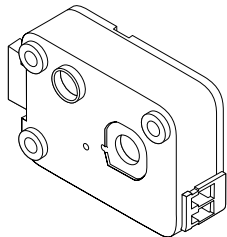

| Part Number    | Description                       | Price    |
|----------------|-----------------------------------|----------|
| 6040002Q-00-00 | Dead Bolt Lock, Standard Hardware | \$241.50 |

|                |   |          |
|----------------|---|----------|
| 6034002Q-00-00 | Spring Bolt Lock (without bolt sensor switch),<br>Standard Hardware | \$236.25 |
|----------------|---|----------|

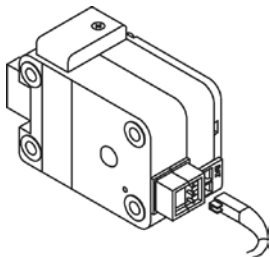

| Part Number     | Description   | Price    |
|-----------------|---|----------|
| *6441A62Q-40-00 | 4-Wheel Override Lock Threaded Cam<br>(For TL15+, use of a Redundant Mechanical Lock<br>Recommended), Standard Hardware | \$345.45 |

\*Dial sold separately.

**ENTRY**

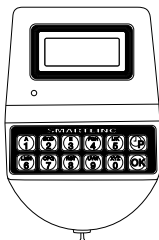

| Part Number | Description   | Price    |
|-------------|---|----------|
| 9030        | SmartLinc Logic Module, Satin Chrome<br>Standard Hardware (Mounting Plate included) | \$588.00 |

**ACCESSORIES (Ordered Separately)**

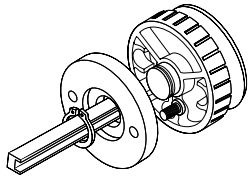

| Part Number | Description   | Price   |
|-------------|---|---------|
| 2666        | Knob Assembly (for use with either Dead Bolt or Spring Bolt Lock) | \$34.65 |

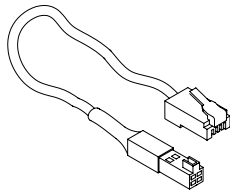

| Part Number | Description                          | Price   |
|-------------|--------------------------------------|---------|
| 43099-1     | Cable Assembly, SmartLinc Lock - 18" | \$18.90 |
| 43099-3     | Cable Assembly, SmartLinc Lock - 3'  | \$19.95 |
| 43099-6     | Cable Assembly, SmartLinc Lock - 6'  | \$22.05 |
| 43099-10    | Cable Assembly, SmartLinc Lock - 10' | \$26.25 |

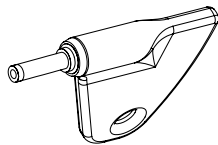

| Part Number | Description | Price   |
|-------------|-------------|---------|
| 40169       | eKEY II     | \$19.95 |

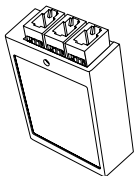

| Part Number | Description   | Price   |
|-------------|---|---------|
| 4006        | Interface Box<br>One 18" SmartLinc Lock Cable Assembly Included | \$78.75 |

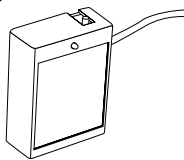

| Part Number | Description | Price   |
|-------------|-------------|---------|
| 4007        | Open Device | \$99.75 |

**Programming & Audit**

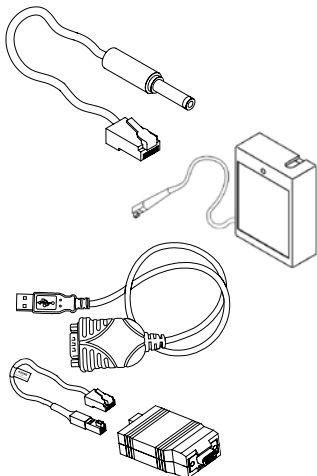

| Part Number | Description   | Price   |
|-------------|---|---------|
| 43097       | SmartLinc Logic Module Programming and Audit Cable                      | \$26.10 |
| 6066        | Lock Reset Box  | \$72.50 |
| 701105      | Smart Series Lock Programming Cable with Serial Interface & USB Adapter | \$94.50 |
| SW7578      | SmartLinc Set-up Software   | N/C     |
| SW7582      | Total Audit Software  | N/C     |

Note: Programming & Audit Software available for download at [www.kaba-mas.com](http://www.kaba-mas.com).

**ACCESSORIES CONTINUED (Ordered Separately)**

| Part Number | Description  | Price    |
|-------------|--|----------|
| 701107      | AC Power Supply, Universal with Multiple Adapter Plug Kit                  | \$99.75  |
| 701115      | AC Power Supply, Universal with Battery Backup & Multiple Adapter Plug Kit | \$175.00 |

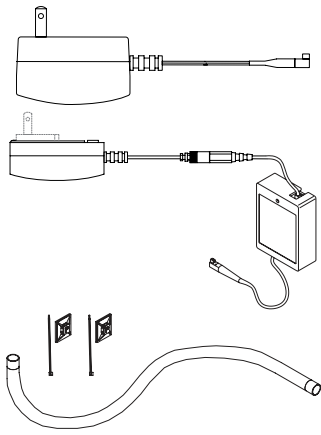

| Part Number | Description   | Price   |
|-------------|---------------|---------|
| 43116       | Armored Cable | \$23.10 |

**Battery Box**

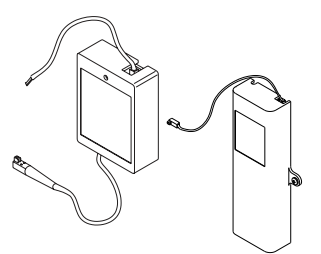

| Part Number | Description   | Price   |
|-------------|---|---------|
| 4001        | Large Battery Box (Six C Cell Batteries Required)                         | \$21.00 |
| 2789-NC*    | Small Alarm/Battery Box (Normally Closed) (One 9v Battery Required)       | \$78.75 |
| 4002*       | Large Alarm/Battery Box (Normally Closed) (Six C Cell Batteries Required) | \$94.50 |

\* Can be configured as either NC or NO by changing the internal jumper.

Batteries not included.

**CONFIGURATION REQUIREMENTS**

| ITEM  | ONE LOCK | TWO LOCKS | THREE LOCKS | FOUR LOCKS | FIVE LOCKS |
|---|----------|-----------|-------------|------------|------------|
| Logic Module - 9030   | One      | One       | One         | One        | One        |
| Lock - select from 4300002Q-00-00, 6040002Q-00-00, 6034002Q-00-00 or 6441A62Q-00-00.            | One      | Two       | Three       | Four       | Five       |
| Lock programming cable (43098)  | One      | One       | One         | One        | One        |
| Logic Module programming/audit cable (43087)  | One      | One       | One         | One        | One        |
| Interface box (4006). Includes one 18" lock cable assembly.                                     | None     | One       | One         | Two        | Two        |
| Lock cable assembly - 18" (43099-1) one supplied std. Also available in 3', 6' and 10' lengths. | None     | One       | Two         | Three      | Four       |
| A/C Power Supply (701107) (Optional)  | One      | One       | One         | One        | One        |
| Program/Audit Software  | One      | One       | One         | One        | One        |

**LOCKS**

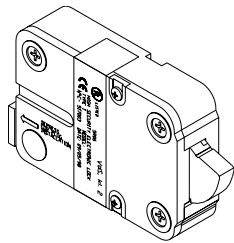

| Part Number    | Description                                    | Price    |
|----------------|--|----------|
| 4300007B-00-00 | Dual-Handed Swing Bolt Lock, Standard Hardware | \$282.45 |

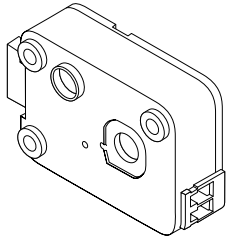

| Part Number    | Description                       | Price    |
|----------------|-----------------------------------|----------|
| 6040007B-00-00 | Dead Bolt Lock, Standard Hardware | \$288.75 |

|                |                                     |          |
|----------------|-------------------------------------|----------|
| 6034007B-00-00 | Spring Bolt Lock, Standard Hardware | \$288.75 |
|----------------|-------------------------------------|----------|

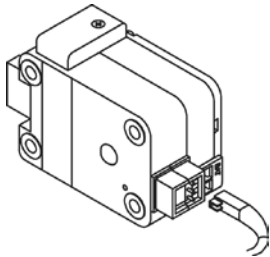

| Part Number    | Description   | Price    |
|----------------|---|----------|
| 6441007B-00-00 | 4-Wheel Override Lock Threaded Cam<br>(Dial sold separately), Standard Hardware | \$408.45 |

**ENTRY**

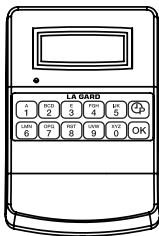

| Part Number | Description  | Finish       | Price    |
|-------------|--|--------------|----------|
| 9150        | SmartLinc II Logic Module<br>Standard Hardware (Mounting Plate included) | Satin Chrome | \$650.00 |

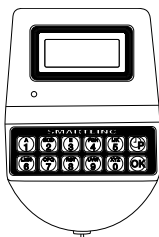

| Part Number | Description   | Finish       | Price    |
|-------------|---|--------------|----------|
| 9050        | SmartLinc II Logic Module<br>Standard Hardware (Mounting Plate included)<br>To be discontinued. Consult factory for availability. | Satin Chrome | \$796.95 |

**ACCESSORIES (Ordered Separately)**

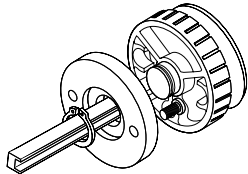

| Part Number | Description   | Price   |
|-------------|---|---------|
| 2666        | Knob Assembly (For use with either Dead Bolt or Spring Bolt Lock) | \$34.65 |

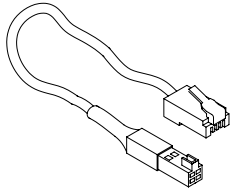

| Part Number | Description          | Price   |
|-------------|----------------------|---------|
| 43099-1     | Cable Assembly - 18" | \$18.90 |
| 43099-3     | Cable Assembly - 3'  | \$19.95 |
| 43099-6     | Cable Assembly - 6'  | \$22.05 |
| 43099-10    | Cable Assembly - 10' | \$26.25 |

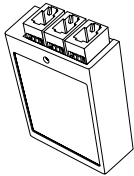

| Part Number | Description                                      | Price   |
|-------------|--|---------|
| 4006        | Interface Box<br>One 18" Cable Assembly Included | \$78.75 |

**Programming & Audit**

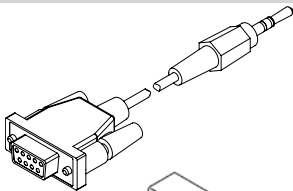

| Part Number | Description   | Price    |
|-------------|---|----------|
| 2041        | SmartLinc II/SmartPoint Logic Module Programming and Audit Cable        | \$68.25  |
| 6066        | Lock Reset Box  | \$72.50  |
| 701105      | Smart Series Lock Programming Cable with Serial Interface & USB Adapter | \$94.50  |
| *707000     | SmartLinc II/SmartPoint Programming & Audit Software                    | \$200.00 |

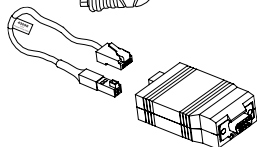
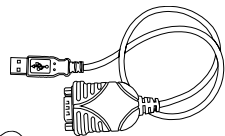
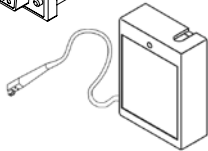

\*Programming cables (701105 & 2041) and power adapters (701107 or 701115) must be ordered separately.

**ACCESSORIES CONTINUED (Ordered Separately)**

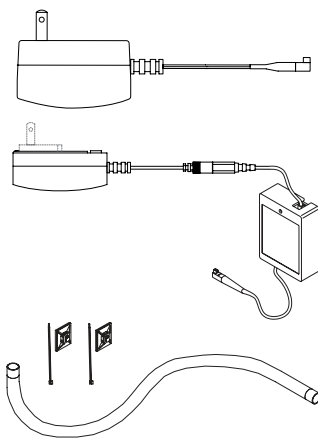

| Part Number | Description  | Price    |
|-------------|--|----------|
| 701107      | AC Power Supply, Universal with Multiple Adapter Plug Kit                  | \$99.75  |
| 701115      | AC Power Supply, Universal with Battery Backup & Multiple Adapter Plug Kit | \$175.00 |

**Note: SmartLinc II is recommended to be operated by AC power.**

| Part Number | Description   | Price   |
|-------------|---------------|---------|
| 43116       | Armored Cable | \$23.10 |

**Battery Box**

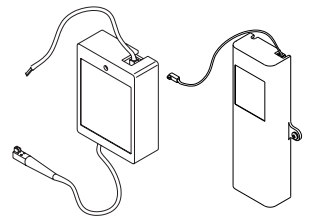

| Part Number | Description   | Price   |
|-------------|---|---------|
| 4001        | Large Battery Box (Six C Cell Batteries Required)                         | \$21.00 |
| 2789-NC*    | Small Alarm/Battery Box (Normally Closed) (One 9v Battery Required)       | \$78.75 |
| 4002*       | Large Alarm/Battery Box (Normally Closed) (Six C Cell Batteries Required) | \$94.50 |

\* Can be configured as either NC or NO by changing the internal jumper.

**Batteries not included.**

**CONFIGURATION REQUIREMENTS**

| ITEM   | ONE LOCK | TWO LOCKS | THREE LOCKS | FOUR LOCKS | FIVE LOCKS |
|--|----------|-----------|-------------|------------|------------|
| Logic Module - 9050/9150   | One      | One       | One         | One        | One        |
| Lock - select from 4300007B-00-00, 6040007B-00-00, 6034007B-00-00 or 6441007B-00-00            | One      | Two       | Three       | Four       | Five       |
| Lock programming cable w/ Serial & USB interface (701105)                                      | One      | One       | One         | One        | One        |
| Logic Module programming cable (2041)  | One      | One       | One         | One        | One        |
| Interface box (4006). Includes one 18" lock cable assembly                                     | None     | One       | One         | Two        | Two        |
| Lock cable assembly - 18" (43099-1) one supplied std. Also available in 3', 6' and 10' lengths | None     | One       | Two         | Three      | Four       |
| A/C Power Supply (701107 or 701115)  | One      | One       | One         | One        | One        |
| Program/Audit Software   | One      | One       | One         | One        | One        |

**LOCKS**

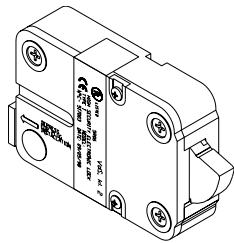

| Part Number    | Description                                    | Price    |
|----------------|--|----------|
| 4300007B-00-00 | Dual-Handed Swing Bolt Lock, Standard Hardware | \$282.45 |

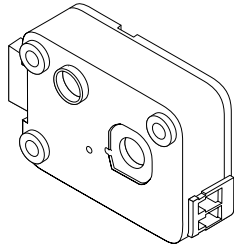

| Part Number    | Description                       | Price    |
|----------------|-----------------------------------|----------|
| 6040007B-00-00 | Dead Bolt Lock, Standard Hardware | \$288.75 |

|                |                                     |          |
|----------------|-------------------------------------|----------|
| 6034007B-00-00 | Spring Bolt Lock, Standard Hardware | \$288.75 |
|----------------|-------------------------------------|----------|

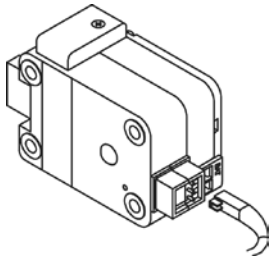

| Part Number    | Description   | Price    |
|----------------|---|----------|
| 6441007B-00-00 | 4-Wheel Override Lock Threaded Cam<br>(Dial sold separately), Standard Hardware | \$408.45 |

**ENTRY**

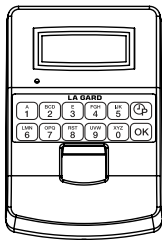

| Part Number | Description  | Finish       | Price    |
|-------------|--|--------------|----------|
| 9160        | SmartPoint Logic Module<br>Standard Hardware (Mounting Plate included) | Satin Chrome | \$880.00 |

Note: For UL approved Module, order 9160-1.

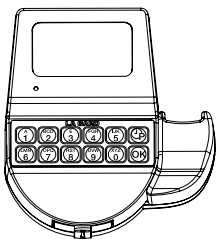

| Part Number | Description   | Finish       | Price     |
|-------------|---|--------------|-----------|
| 9060        | SmartPoint Logic Module<br>Standard Hardware (Mounting Plate included)<br>To be discontinued. Consult factory for availability. | Satin Chrome | \$1038.45 |

Note: For UL approved Module, order 9060-1.



**ACCESSORIES (Order Separately)**

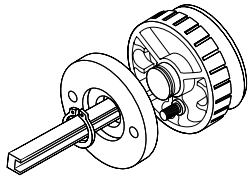

| Part Number | Description   | Price   |
|-------------|---|---------|
| 2666        | Knob Assembly (For use with either Dead Bolt or Spring Bolt Lock) | \$34.65 |

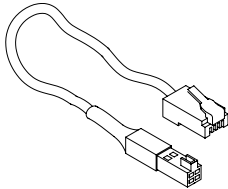

| Part Number | Description          | Price   |
|-------------|----------------------|---------|
| 43099-1     | Cable Assembly - 18" | \$18.90 |
| 43099-3     | Cable Assembly - 3'  | \$19.95 |
| 43099-6     | Cable Assembly - 6'  | \$22.05 |
| 43099-10    | Cable Assembly - 10' | \$26.25 |

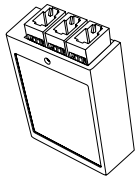

| Part Number | Description   | Price   |
|-------------|---|---------|
| 4006        | Interface Box<br>One 18" Lock Cable Assembly Included | \$78.75 |

**Programming & Audit**

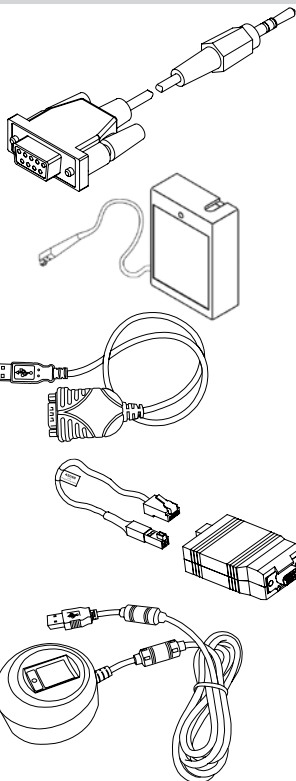

| Part Number | Description   | Price    |
|-------------|---|----------|
| 2041        | SmartLinc II/SmartPoint Logic Module Programming and Audit Cable        | \$68.25  |
| 6066        | Lock Reset Box  | \$72.50  |
| 701105      | Smart Series Lock Programming Cable with Serial Interface & USB Adapter | \$94.50  |
| 702003      | USB Fingerprint Reader  | \$420.00 |
| *707000     | SmartLinc II/SmartPoint Programming & Audit Software                    | \$200.00 |

\*Programming cables (701105 & 2041) and power adapters (701107 or 701115) must be ordered separately.

**ACCESSORIES CONTINUED (Order Separately)**

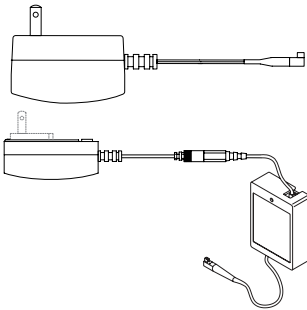

| Part Number | Description   | Price    |
|-------------|---|----------|
| 701107      | AC Power Supply, Universal<br>with Multiple Adapter Plug Kit                  | \$99.75  |
| 701115      | AC Power Supply, Universal<br>with Battery Backup & Multiple Adapter Plug Kit | \$175.00 |

**Note:** SmartPoint is recommended to be operated by AC power.

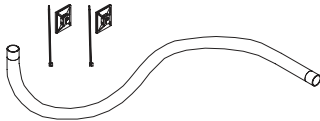

| Part Number | Description             | Price   |
|-------------|-------------------------|---------|
| 43116       | Armored Cable Protector | \$23.10 |

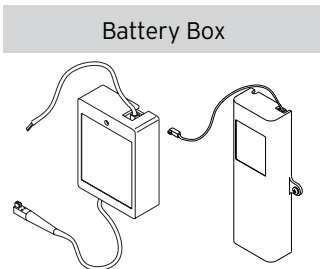

Battery Box

| Part Number | Description  | Price   |
|-------------|--|---------|
| 4001        | Large Battery Box (Six C Cell Batteries Required)                            | \$21.00 |
| 2789-NC*    | Small Alarm/Battery Box (Normally Closed)<br>(One 9v Battery Required)       | \$78.75 |
| 4002*       | Large Alarm/Battery Box (Normally Closed)<br>(Six C Cell Batteries Required) | \$94.50 |

\* Can be configured as either NC or NO by changing the internal jumper.

Batteries not included.

**NOTE:** Minimum order amount per shipment is \$100.00 net.

**CONFIGURATION REQUIREMENTS**

| ITEM   | ONE LOCK | TWO LOCKS | THREE LOCKS | FOUR LOCKS | FIVE LOCKS |
|--|----------|-----------|-------------|------------|------------|
| Logic Module - 9060/9160   | One      | One       | One         | One        | One        |
| Lock - select from 4300007B-00-00, 6040007B-00-00, 6034007B-00-00 or 6441007B-00-00            | One      | Two       | Three       | Four       | Five       |
| Lock programming cable w/ Serial & USB interface (701105)                                      | One      | One       | One         | One        | One        |
| Logic Module programming cable (2041)  | One      | One       | One         | One        | One        |
| Interface box (4006). Includes one 18" lock cable assembly                                     | None     | One       | One         | Two        | Two        |
| Lock cable assembly - 18" (43099-1) one supplied std. Also available in 3', 6' and 10' lengths | None     | One       | Two         | Three      | Four       |
| A/C Power Supply (701107 or 701115)  | One      | One       | One         | One        | One        |
| Program/Audit Software   | One      | One       | One         | One        | One        |

# ACCESSORIES

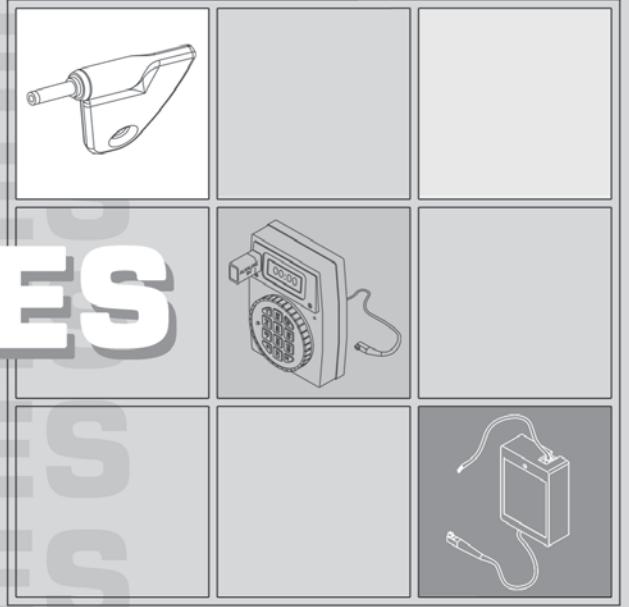

**LA GARD**

**Electronic**

ACCESSORIES (Order Separately)

| Part Number | Description  | Price   |
|-------------|--|---------|
| 3015-A      | Hardware Pack Entry: 3000, 3715, 9050, 9150, 9060, 9160        | \$6.85  |
| 3015-C      | Hardware Pack Dead Bolt: 3740, 6040, 6034                      | \$4.45  |
| 3015-DH     | Hardware Pack Swing Bolt: 4200, 6034                           | \$2.40  |
| 2700-AE     | Hardware Pack Entry: 3710                                      | \$4.50  |
| 2700-B      | Hardware Pack Entry: 3035, 3125                                | \$6.85  |
| 3755-1      | Hardware Pack Entry: 3190; 3750                                | \$13.15 |
| 6980-1      | Hardware Pack Redundant Locks                                  | \$12.60 |
| 704001      | Metric Hardware Pack Dead Bolt: 3740, 6040, 6034               | \$4.45  |
| 704002      | Metric Hardware Pack Swing Bolt: 4200, 4300                    | \$2.35  |
| 704007      | Metric Hardware Pack Entry: 3000, 3715, 9050, 9150, 9060, 9160 | \$6.85  |
| 704008      | Metric Hardware Pack Entry: 3710                               | \$4.40  |
| 704009      | Metric Hardware Pack Entry: 3035, 3125                         | \$6.85  |
| 704010      | Metric Hardware Pack Entry: 3190; 3750                         | \$13.15 |
| 704112      | Standard & Metric Hardware Pack Entry: 8130                    | \$16.50 |

| Part Number | Description                               | Price   |
|-------------|---|---------|
| 2788        | Small Battery Box                         | \$11.10 |
| 4001        | Large Battery Box                         | \$21.00 |
| 2789-NC     | Small Alarm/Battery Box (Normally Closed) | \$78.75 |
| 4002        | Large Alarm/Battery Box (Normally Closed) | \$94.50 |

| Part Number | Description   | Price   |
|-------------|---|---------|
| 42160       | Serial Interface for 3125 Entry   | \$80.85 |
| 43097       | Programming & Audit Cable for 3750-K, 3190, 8130 & SmartLinc (9030) Entries | \$26.10 |
| 6066        | Lock Reset Box  | \$72.50 |
| 702005      | USB to Serial Cable   | \$84.00 |
| 42150       | Serial Interface  | \$45.30 |
| 42145       | Programming & Audit Cable for 3125 Entry                                    | \$33.10 |

| Part Number | Description                 | Price   |
|-------------|-----------------------------|---------|
| 3122        | E-Key (for 3125 Entry only) | \$17.85 |
| 40169       | E-Key II                    | \$19.95 |

| Part Number | Description   | Price    |
|-------------|---|----------|
| 702003      | SmartPoint USB Fingerprint Reader                     | \$420.00 |
| 707011      | Gard Series USB Interface (with 42145 & 43097 Cables) | \$145.00 |
| 707010      | Gard Series USB Interface ONLY                        | \$105.00 |

| Part Number | Description   | Price    |
|-------------|---|----------|
| 3188        | Relock Bracket Extension  | \$4.50   |
| 2666        | Knob Assembly   | \$34.65  |
| 43098       | Smart Series Lock Programming Cable   | \$22.10  |
| 43099-1     | 18" Smart Series Lock Cable   | \$18.90  |
| 43099-3     | 36" Smart Series Lock Cable   | \$19.95  |
| 43099-6     | 72" Smart Series Lock Cable   | \$22.05  |
| 43099-10    | 120" Smart Series Lock Cable  | \$26.25  |
| 4006        | Smart Series Interface Box  | \$78.75  |
| 4007        | SmartLinc Open Device   | \$99.75  |
| 701107      | AC Power Supply, Universal, with Multiple Adapter Plug Kit                  | \$99.75  |
| 701115      | AC Power Supply, Universal, with Battery Backup & Multiple Adapter Plug Kit | \$175.00 |
| 43116       | Armored Cable (SmartLinc II and SmartPoint)                                 | \$23.10  |
| 2957        | Relocker Right Hand   | \$10.00  |
| 2959        | Relocker Left Hand  | \$10.00  |
| 3716        | Dial Plate Adaptor for 3710 Entry   | \$6.85   |



The Kaba Safe Lock Division relies on product innovation to meet our markets' ever-changing needs for loss prevention and access control solutions.

The Kaba and LA GARD brands are synonymous worldwide with security, control and accountability.

Kaba AG | Kaba Mas | Kaba Mauer GmbH

**Kaba Mas LLC**

749 W. Short St.

Lexington, KY 40508

phone 859-253-4744

toll-free 877-KabaMas (522-2627)

fax 859-255-2655

web [www.kaba-mas.com](http://www.kaba-mas.com)

LGLPB#4.07/2010.1K